

City of Silver Lake



ORDINANCE NO. 2563

AN ORDINANCE ADOPTING A NEW ZONING MAP FOR THE CITY OF SILVER LAKE, KANSAS AND INCORPORATING SUCH MAP BY REFERENCE

WHEREAS, the City of Silver Lake, with the adoption of Ordinances No. 1276, 1285, 1293, 1349, 1467, 1565, 1571, 1585, 1609, 1615, 1616, 1691, 1702, 1743, 1769, 1784, 1920, 2034, 2152, 2244, 2264, 2392, and Resolution No. 2022-02, which all amended the City's Zoning Map;

WHEREAS, the City desires to amend its official Zoning Map to elect changes in zoning classifications established as a result of the aforementioned amendments to the Zoning Map;

BE IT ORDAINED BY THE GOVERNING BODY OF THE CITY OF SILVER LAKE, KANSAS:

SECTION 1. ZONING MAP; ADOPTED. A new Zoning Map is hereby approved. The new Zoning Map is hereby declared to be approved and incorporated by reference.

SECTION 2. OFFICIAL COPY; ZONING MAP. In accordance with K.S.A. 12-3010 at least one copy of the Zoning Map, marked, "Official Copy as Incorporated by Reference by Ordinance No. 2563," and to which there shall be attached a published copy of this Ordinance, and filed in the office of the City Clerk to be open to inspection and available to the public at all reasonable hours.

SECTION 3. SEVERABILITY. Any provision of this Ordinance which shall be declared invalid shall not affect the validity and authority of any other provisions of this Ordinance.

SECTION 4. REPEAL OF CONFLICTING ORDINANCES. Previous Ordinances and any parts of Ordinances in conflict herewith are hereby repealed.

SECTION 5. EFFECTIVE DATE. This Ordinance shall take effect and be in force from and after its publication in the Official City Newspaper as provided by law.

[REMAINDER OF PAGE LEFT BLANK]

PASSED AND ADOPTED this 17th day of April, 2023.

CITY OF SILVER LAKE, KANSAS

By: *Mack Smith*
Mack Smith, Mayor

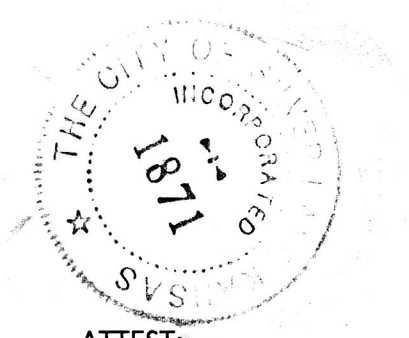

ATTEST:

Liz Steckel
Liz Steckel, City Clerk

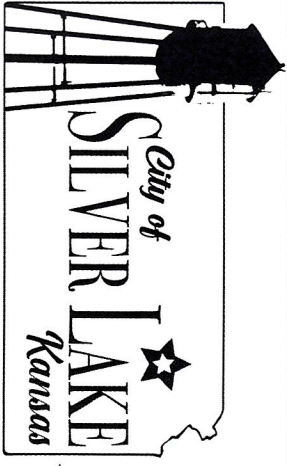

ZONING MAP

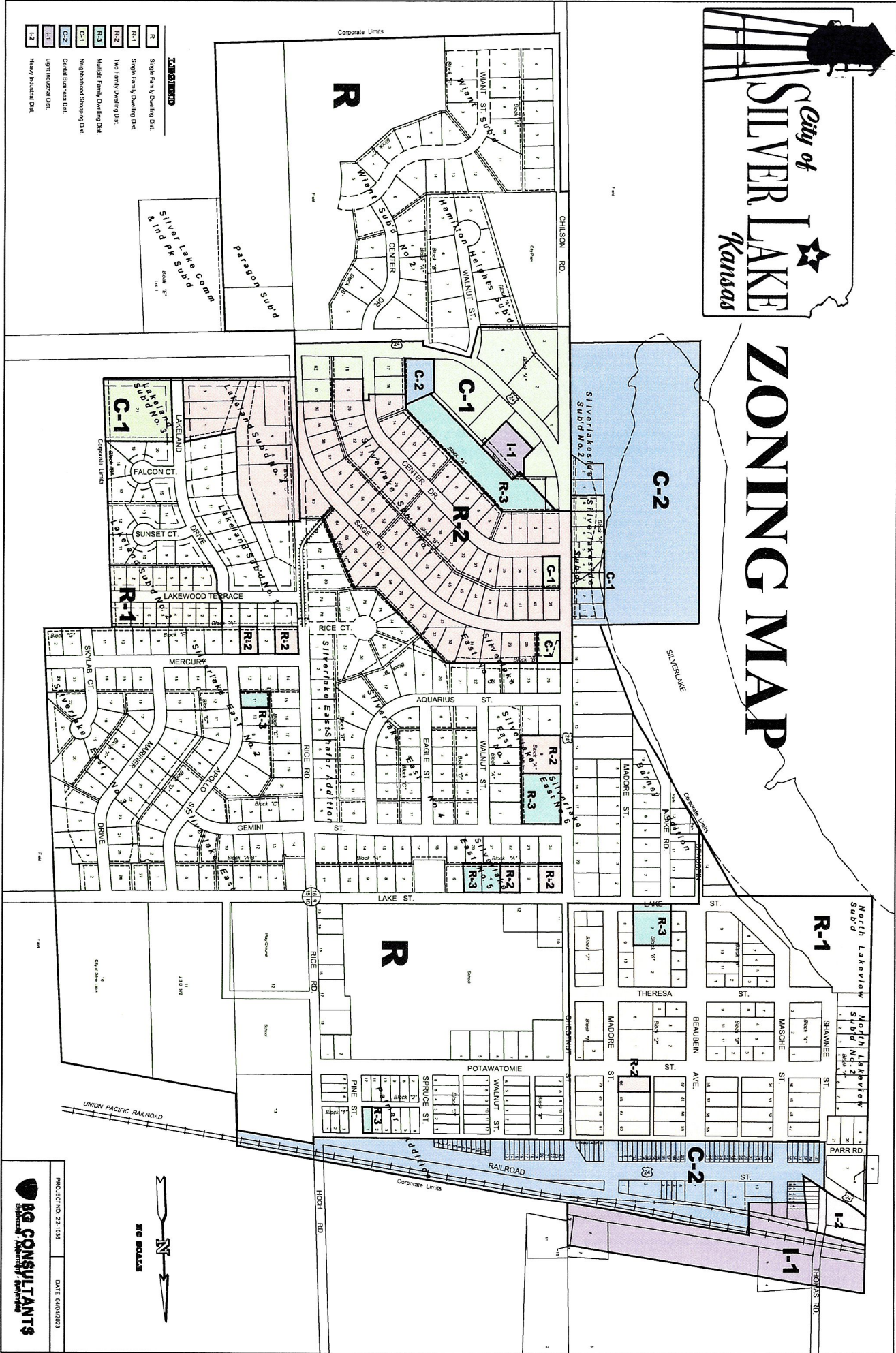

LEGEND

R	Single Family Dwelling Dist.
R-1	Single Family Dwelling Dist.
R-2	Two Family Dwelling Dist.
R-3	Multiple Family Dwelling Dist.
C-1	Neighborhood Shopping Dist.
C-2	Central Business Dist.
I-1	Light Industrial Dist.
I-2	Heavy Industrial Dist.



RQ CONSULTANTS
 PROJECT NO. 22-185
 DATE: 04/24/2023



ZONING MAP

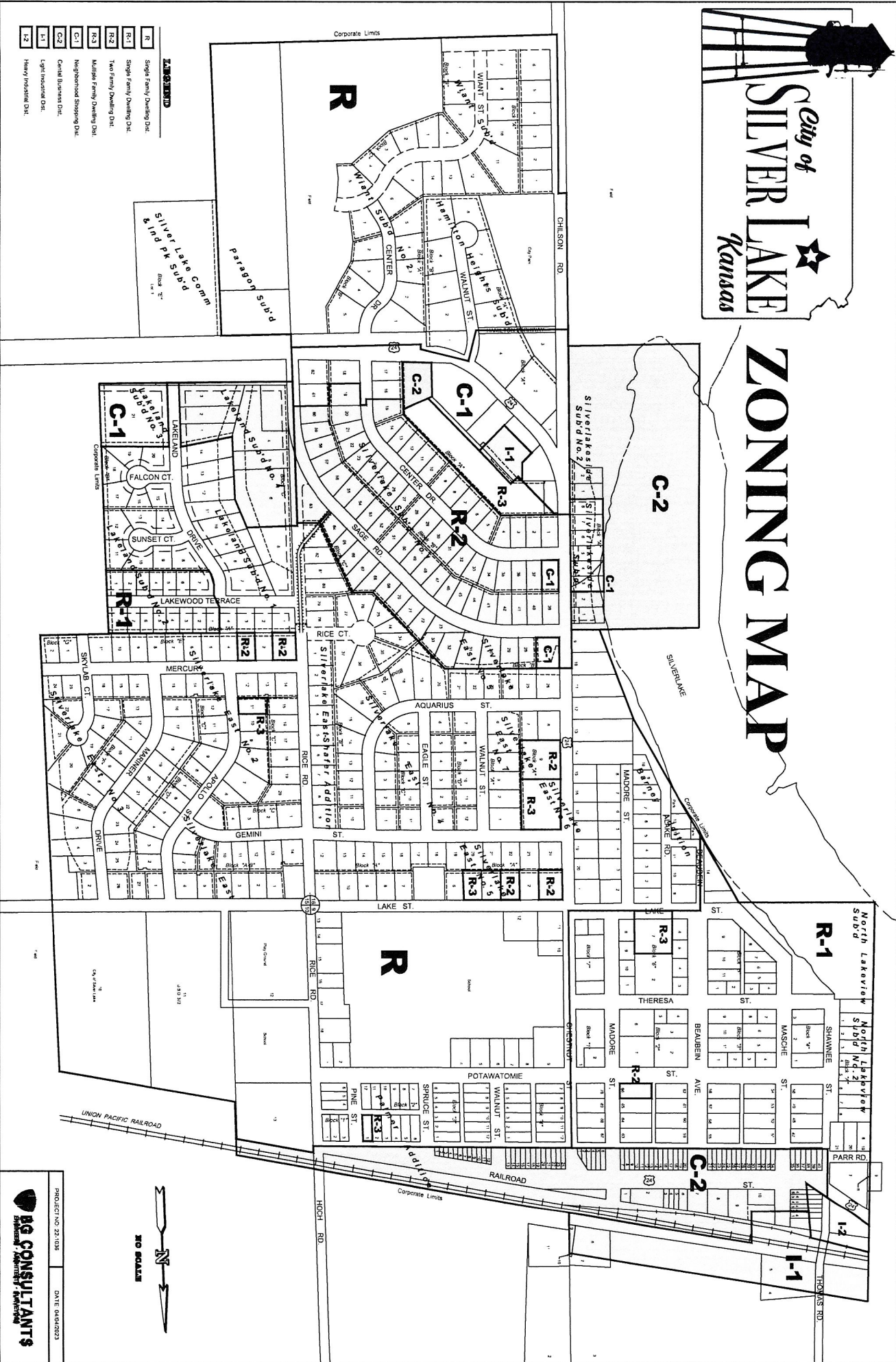

R	Single Family Dwelling Dist.
R-1	Single Family Dwelling Dist.
R-2	Two Family Dwelling Dist.
R-3	Multiple Family Dwelling Dist.
C-1	Neighborhood Shopping Dist.
C-2	Central Business Dist.
I-1	Light Industrial Dist.
I-2	Heavy Industrial Dist.

LEGEND
 Silver Lake Comm & Ind Pk Subd
 Road 7'

PROJECT NO: 23-1038 DATE: 04/04/2023

RG CONSULTANTS
 Regional Management Solutions

